

MONMOUTH

PROPERTY MAPS

Tax Map U27

LITCHFIELD

Kennebec County, ME

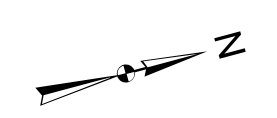

LEGEND

- PROPERTY LINE
- ROADWAY
- PRIVATE RIGHT-OF-WAY
- HISTORIC/SUBDIVISION LINE
- EASEMENT
- STREAMS
- PARCEL HOOK
- 2-1 PARCEL ID NUMBER
- 150' SURVEY DIMENSION (FEET)
- 1.25 AC ASSESSED ACREAGE
- 1 SURVEY LOT NUMBER
- HYDROLOGY
- WETLANDS

The information on this map is for assessment purposes only, is not a legal survey, and is not intended to be used for conveyance.

SCALE: 1 in = 100 ft

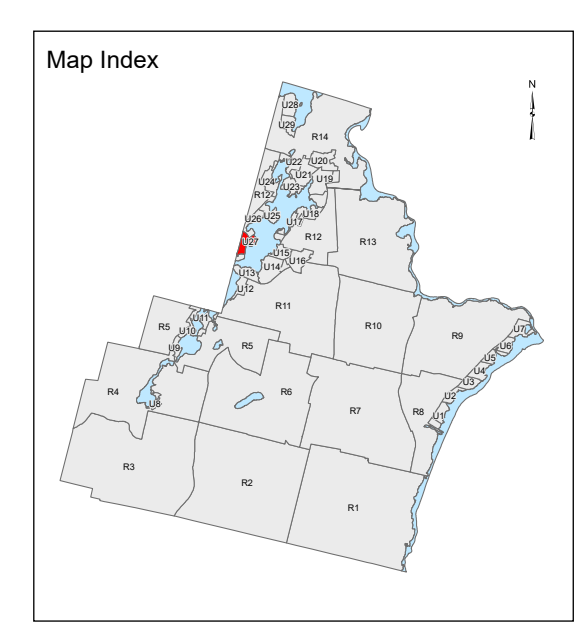
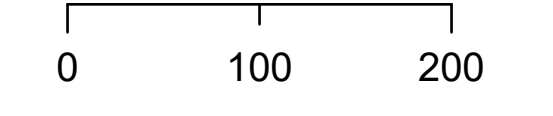

Original map created by John E. O'Donnell & Associates, Inc.
Map updated by LatLong Logic, LLC

Assessment date: April 1, 2025
Print date: 4/29/2026

Litchfield Assessor's Office
2400 Hallowell Road
Litchfield, Maine 04350
(207) 268-4721

U27

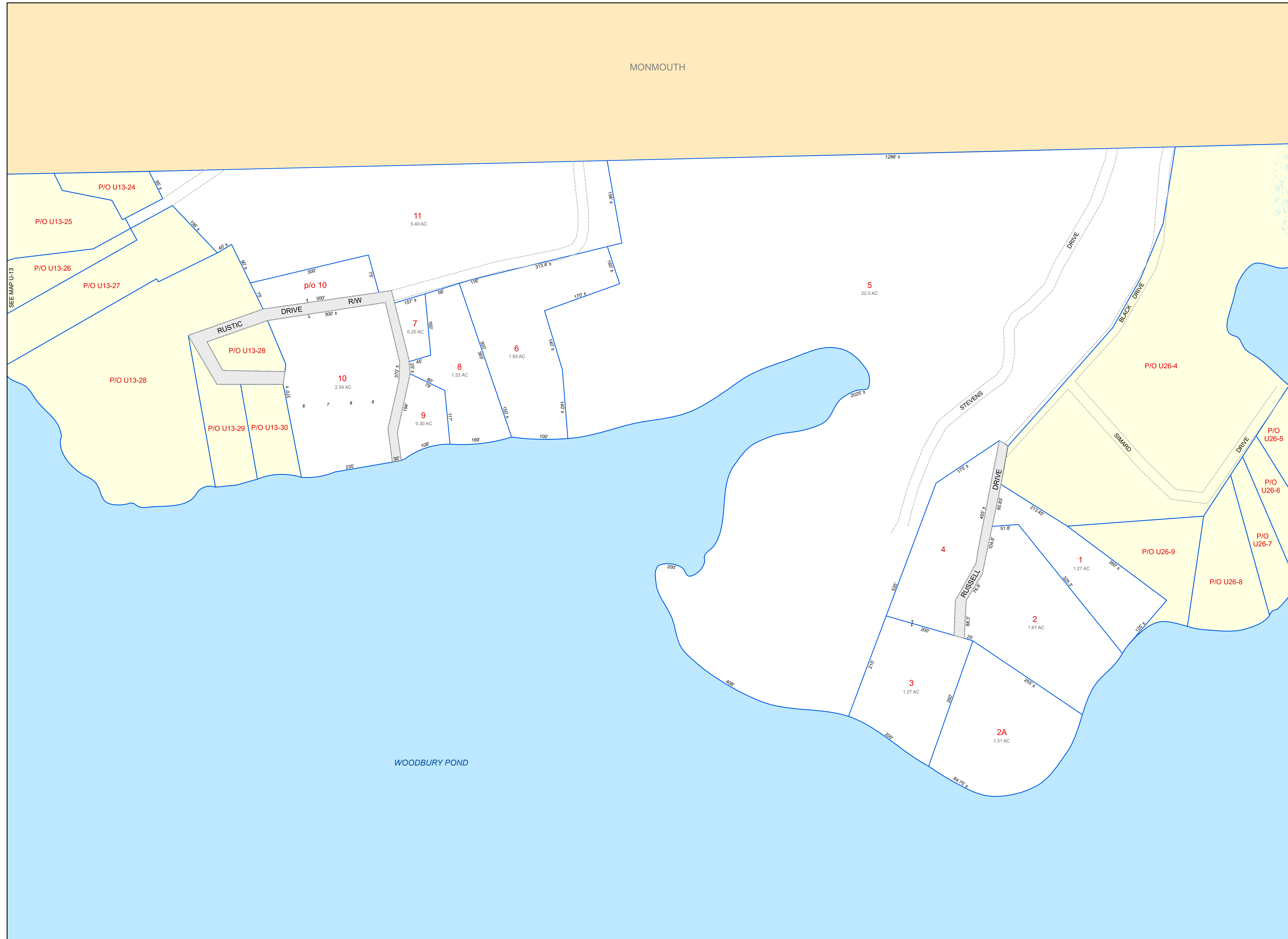

SEE MAP U-13

SEE MAP U-28

WOODBURY POND